



# Motocross European Championships

## Supplementary Regulations

Title of the meeting:

**EMX 65 EUROPEAN CHAMPIONSHIP MOTOCROSS FINAL**  
**EMX 85 EUROPEAN CHAMPIONSHIP MOTOCROSS FINAL**

Venue: **LOKET** EMN: **20/21**  
Classes: **EMX 65, EMX 85 (Finals)** Date: **22.- 23.07.2017**

Organizing FMN: **ACCR** Country: **Czech Republic**

### Access:

Nearest Airport: **VACLAV HAVEL AIRPORT PRAGUE** at: **120** km from the circuit  
Motorway: **E48** National Road: **6**  
Nearest town: **Loket** at: **2** km from the circuit  
Direction: **West** (North/South/West/East)  
Nearest Hospital: **Sokolov** at: **10** km from the circuit

Hospital Address: **Slovenská 545, CZ 356 01 Sokolov**

Phone: + **420 352 520 111** E-Mail: **adlofova@nemosgroup.cz**

Web.Site: **www.nemosok.cz** GBS: **50°10'38.68" N, 12°39'1.61" E**

### 1. ORGANIZER:

Address: **AUTOMOTOKLUB LOKET v ACR**

**Na Vyhliďce 592, CZ 357 33 Loket**

**Czech Republic**

Phone: + **420 352 684 023** Fax: +

E-Mail: **dvorak.amk.loket@tiscali.cz**

Web.Site: **www.loketmx.com**

### 2. ENTRIES:

Entry forms duly approved by the participants must be send to:

**YouthStream Sport Office**

Address:

Phone: + **49 69 63300743** Fax: + **496 330 076 643**

E-Mail: **sportoffice@youthstream.org**

not later than: **22.6.2017** (30 days before the meeting)

### 3. SECRETARIAT OF THE MEETING:

Address: **Loket - near te circuit**

**AUTOMOTOKLUB LOKET v ACR, Na Vyhliďce 592, CZ 357 33 Loket**

**Czech Republic**

Phone: + **420 352 684 023**

E-Mail: **dvorak.amk.loket@tiscali.cz**

### 4. WELCOME CENTER:

Place: **Loket - near te circuit GPS: 50°12'21.778"N, 12°45'59.778"E**

Open on: Thursday: from: **02.p.m.** to: **08.p.m.**

Friday: from: **08.p.m.** to: **08.p.m.**

Saturday: from: **06.am.** to: **08.p.m.**

Sunday: from: **07.a.m.** to: **02.p.m.**

### 5. CIRCUIT:

Name of the circuit: **LOKETSKÉ SERPENTINY**

Length of the course: **1 586** m. Minimum width: **6** m.

Address: **AUTOMOTOKLUB LOKET v ACR, Na Vyhliďce 592, CZ 357 33 Loket**

GPS Coordinates: **50°11'44.64"N, 12°45'30.54"E**

A drawing of the circuit is attached to these regulations.

The race office must be equippt with a high speed internet connection over the whole meeting.

### 5 a. TIMEKEEPING:

e- mail address: **timekeeping@youthstream.org**

### 6. OFFICIALS:

FIM Europe Delegate: **Eddie HERD** FIM Lic. Nr. **2701**

FIM/FIM Europe Chief Steward: **Tony SKILLINGTON** FIM Lic. Nr. **2711**

FMNR Steward: **Tomaš HONZIK** FIM Lic. Nr. **2680**

FIM/FIM Europe Race-Director: **Jiri SITINA** FIM Lic. Nr. **2710**

Clerk of the course: **Zdeněk DVORAK** FIM Lic. Nr. **2675**

Secretary of Race Direction: **Pavel POLACEK**

Secretary of the Meeting: **Jana LEHNEROVA**

Chief Technikal Steward: **Jiri CHMEL** FIM Lic. Nr. **tba**

Chief Timekeeper: **Ludwig VERHEYDEN** FIM Lic. Nr. **10547**

Environmental Steward: **Josef SPERL** FIM Lic. Nr. **10103**

Chief Medical Officer: **Věra PROCHAZKOVA** FIM Lic. Nr. **11098**

Press Officer: **Tereza Piela**

Paddock Official: **Jaroslav Fařlák ml.**

The meeting will be organized in conformity with the FIM-E Sporting Code, the FIM-E MX rules and the CMS Regulations, the general rules of the **ACCR** (FMNR), where applicable, and this Supplementary Regulations which have been duly examined and approved by the **ACCR**.

**7. STARTING NUMBERS:**

All riders will receive from the FIM Europe Motocross Commission, or from Youthstream in the case of events combined with MXGP/MX2 a permanent starting number to be used for the entire season. Changing during the season without prior written approval of the FIM Europe.

**8. CIRCUIT CONTROL:**

Meeting point: At the starting grid.  
See attached Time Schedule.

**9. MEETING WITH THE ORGANIZERS**

Venue: Jury room.  
See attached Time Schedule.

**10. TECHNICAL CONTROL AND VERIFICATIONS.**

Venue: The Technical control post.  
See attached Time Schedule.

**11. JURY MEETINGS**

Venue: The Jury room.  
See attached Time Schedule.

**12. RIDERS BRIEFING:**

Meeting point: At the starting grid.  
See attached Time Schedule.

**13. PRACTISE:**

See attached Time Schedule

**14. QUALIFYING:**

See attached Time Schedule

**15. FREE START SESSION:**

See attached Time Schedule

**16. WARM UP:**

See attached Time Schedule

**17. SIGHTING LAP:**

See attached Time Schedule

**18. WAITING ZONE:**

See attached Time Schedule

**19. RACES:**

See attached Time Schedule

**20. FUEL:**

In according with FIM specifications.

**21. INSURANCE:**

The organizer has contacted a third party insurance in according with Art. 110.1 of the FIM Europe Sporting Code. This insurance includes a guarantee of the minimum amount as stipulated by the FIM Europe Management Council. The Insurance comes in effect 2 days before the first practise and ends 2 days after the meeting.

The organizer disclaims all responsibility for damage to a motorcycle, its accessories and components arising out of an accident, fire or other incident.

**22. PROTEST AND APPEALS:**

Any person or group of persons (rider, entrant, manufacturer, official, etc.), recognized by the FIM and concerned by a decision taken under the authority of the FIM Europe, may ask for redress for the consequences of that decision.

Protest must be lodged according to the FIM Europe Disciplinary and Arbitration Code and the Supplementary Regulations and be accompanied by a fee of 130,- € or equivalent amount in local currency, returnable if the protest is justified.

In general, protests against eligibility of a rider entered, must be made before the start of the official practice.

Protests against results must be presented to the International Jury within 30 minutes following the publishing of the results.

An appeal can be made to the FIM Europe Disciplinary Commission against a decision of the International Jury.

Protest entailing a fuel control: See FIM Europe MX rulebooks.

**23. PRIZE-GIVING CEREMONY:**

Venue of the prize-giving ceremony: YouthStream podium

See attached Timetable.

The first three riders are invited to attend the prize-giving ceremony.

Additional other riders can be invited by Youthstream or the organizer. Riders might also be invited for a Press Conference.

If invited attendance to the prize giving ceremony or press conference is compulsory.

**24. INTERPRETATION OF THE SUPPLEMENTARY REGULATIONS:**

The interpretation of this regulations rests entirely with the Jury or Race Direction. In case of dispute, regarding the interpretation or if there is any difference between the two official texts, the English text will prevail.

**25. MISCELLANEOUS:**

The maximum fee for Transponders rent is 100.-€, the fee has to be paid back after return of the Transponder.

**26. ADDITIONAL MISCELLANEOUS:**

At all solo events where the European Championship is combined with FIM World Championship and promoted by Youthstream, there is an entry fee of 300.-€ payable to Youthstream before technical control.

Place and date:

**Loket 21.02.2017**

The race office is equipped with a high speed internet connection over the whole meeting.

The Clerk of the Course:

Mr. Zdeněk Dvořák

Approved by FMNR:

ACCR

Approved by FIM Europe

Eddie Herd 02/03/2017



# MOTOCROSS AREAL "Loketské serpenty"

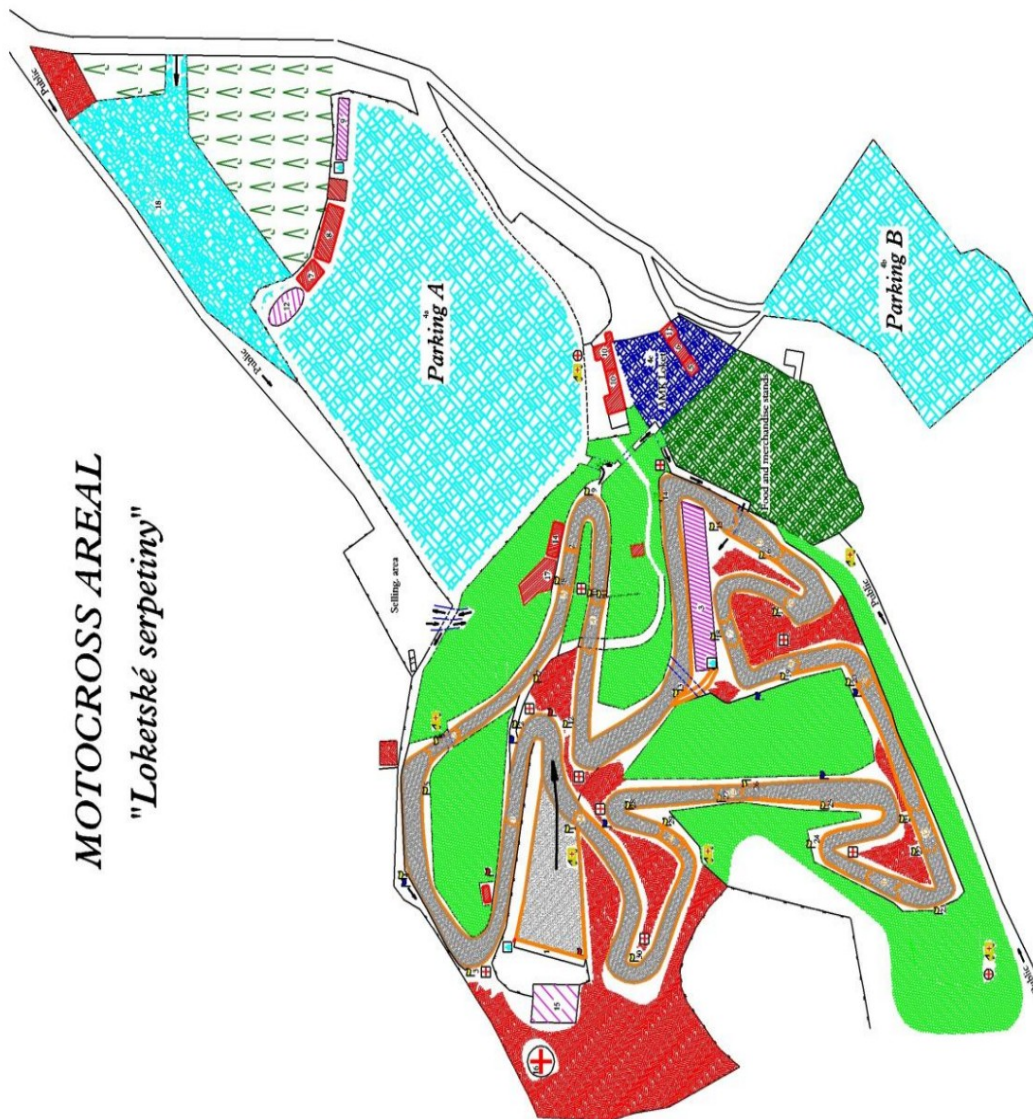

|   |   |   |
|---|---|---|
| <p>1 Start</p> <p>2 1st turn</p> <p>3 2nd turn</p> <p>4 3rd turn</p> <p>5 4th turn</p> <p>6 5th turn</p> <p>7 6th turn</p> <p>8 7th turn</p> <p>9 8th turn</p> <p>10 9th turn</p> <p>11 10th turn</p> <p>12 11th turn</p> <p>13 12th turn</p> <p>14 13th turn</p> <p>15 14th turn</p> <p>16 15th turn</p> <p>17 16th turn</p> <p>18 17th turn</p> | <p>1 Start</p> <p>2 1st turn</p> <p>3 2nd turn</p> <p>4 3rd turn</p> <p>5 4th turn</p> <p>6 5th turn</p> <p>7 6th turn</p> <p>8 7th turn</p> <p>9 8th turn</p> <p>10 9th turn</p> <p>11 10th turn</p> <p>12 11th turn</p> <p>13 12th turn</p> <p>14 13th turn</p> <p>15 14th turn</p> <p>16 15th turn</p> <p>17 16th turn</p> <p>18 17th turn</p> | <p>1 Start</p> <p>2 1st turn</p> <p>3 2nd turn</p> <p>4 3rd turn</p> <p>5 4th turn</p> <p>6 5th turn</p> <p>7 6th turn</p> <p>8 7th turn</p> <p>9 8th turn</p> <p>10 9th turn</p> <p>11 10th turn</p> <p>12 11th turn</p> <p>13 12th turn</p> <p>14 13th turn</p> <p>15 14th turn</p> <p>16 15th turn</p> <p>17 16th turn</p> <p>18 17th turn</p> |
|---|---|---|

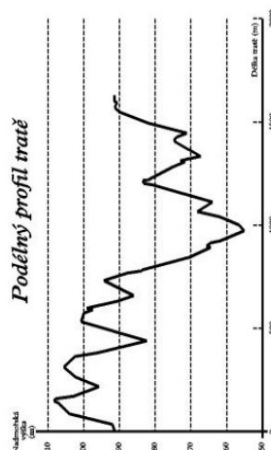

Zaměřila a zpracovala firma:

Ověřil a kontroloval:

